

USP90-ER16-F Ultrasonic Spindle Motor

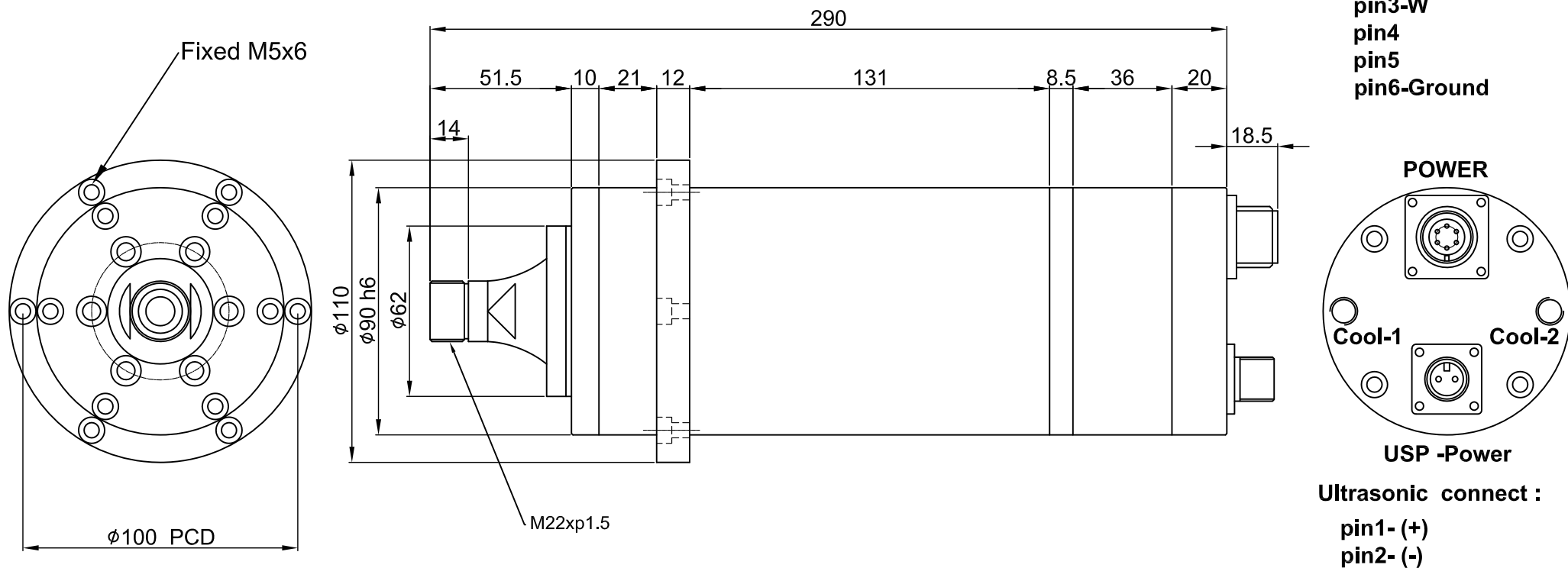

pin1-U
pin2-V
pin3-W
pin4
pin5
pin6-Ground

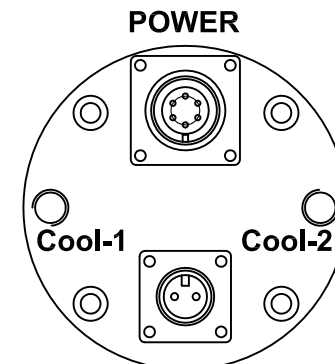

USP -Power

Ultrasonic connect :

pin1- (+)
pin2- (-)

Specification	Data
Motor Type	220V,2P,3 ϕ
Power Output	1.5Kw
Maximun Motor Speed	12000 rpm
Maximun Dynamic Run-out	0.01 mm
Cooling Water Flow Rate	70 l/hr
Cooling Water Inlet Temp.	20 c $^{\circ}$ ~ 24 c $^{\circ}$
Dimension	$\phi 90$ h6
Weight	

*Open the machine every day,
so that the speed of the spindle 0~6000 rpm about 10minutes, slowly accelerated.
The bearing slowly heating, so that the life of the spindle will be longer

*The manufacturer has the power to change the performance and appearance dimensions.
The change is made to the advanced method of the product.

*The spindle mount saddle must be made of an Aluminum Alloy material to avoid ststic or electromagnetic fields.